

**NEVOBAHN 10 mm, with high-tech drainage fleece****Description**

The NEVOBAHN with drainage fleece is a CE-certified drainage foundation wall protection film that separates the masonry from the rest of the soil and ensures the safe drainage of seepage water. The drainage fleece laminated onto the studs prevents the spaces between the studs from silting up and provides an air layer that ensures the seepage water is drained away safely. The outstanding stability of NEVOBAHN - 10 mm WITH HIGH-TECH DRAINAGE FABRIC with a compressive strength of 420 kN per square metre and the excellent drainage properties of 110 l/(ms) are particularly noteworthy. The tear resistance and elongation capacity have of course been tested in accordance with CE DIN EN ISO 13252. The DIN standards for structural waterproofing must be observed.

**Application**

The dimples face the ground, the NEVOBAHN has a flat overlap edge (7 cm) on one long side, the overhanging geotextile also allows an overlap. At least 3 rows of dimples must overlap when laid crosswise. The usability of the product in the respective installation situation must be checked by the user!

**Material**

- High-density polyethylene (HD-PE) - Core product
- Polypropylene (PP) - Drainage fleece
- Free from PVC, CFC and HFC
- Without substances of very high concern according to ECHA candidate list (REACH Regulation)

**Packaging**

- Free of halogen-containing compounds, azo dyes, flame retardants



## NEVOBAHN 10 mm, with high-tech drainage fleece

Item no.	Width m	Length m	Rolls/Pallet	m <sup>2</sup> /Pallet
NBHD1020125	2,00	12,50	6	150,00

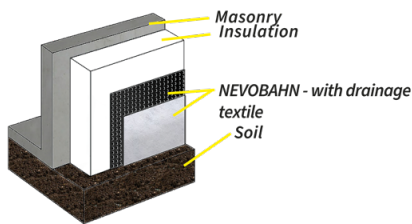
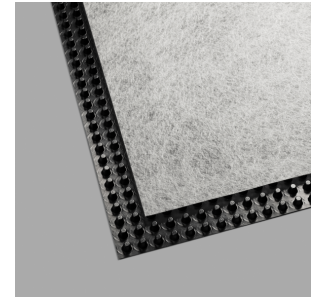

APPLICATION AS FOUNDATION WALL PROTECTION

### Technical data:

Area weight dimpled sheet: approx. 600 g/m<sup>2</sup>

Area weight drainage fleece: approx. 100 g/m<sup>2</sup>

Area weight total: approx. 700 g/m<sup>2</sup>

Dimple height: 10 mm

Number of dimples: approx. 3,360 per m<sup>2</sup>

Air volume between the dimples: approx. 7.9 l/m<sup>2</sup>

Water drainage capacity: approx. 3,8 l/(ms) in accordance with DIN EN ISO 12958

Drainage fleece permeability: 110 x 10<sup>-3</sup> m/s

Compressive strength: approx. 420 kN/m<sup>2</sup> (42 t/m<sup>2</sup>)

Footfall sound reduction in accordance with ISO 10140-1: 33 dB

Temperature resistance: -40 °C to +80 °C

Physiological properties: Safe for drinking water, resistant to chemicals, root-resistant, rot-proof, resistant to fungal and bacterial attack

The recommended installation depth depends on the ground; the following guide values apply:

Installation on a concrete or stone layer 10 m

Installation on a waterproofing layer 7 m

Installation on soft thermal insulation boards (polystyrene) 3.5 m

Installation on pressure-resistant thermal insulation boards (XPS) 7 m

Note: Protect from direct sunlight during storage.

