

Order form - Stremaform® working joints

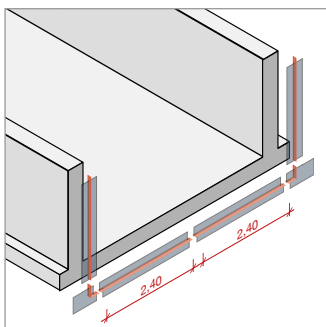

This order sheet has been designed to document your project requirements quickly and efficiently. Please send form to the below address and we will provide a quotation for your requirements:

Max Frank GmbH & Co. KG
 Mitterweg 1
 94339 Leiblfing
 +49 9427 189-0
 info@maxfrank.com

Project name:
 Site address:
 Site contact:

Type of construction

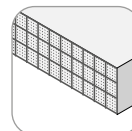

slab

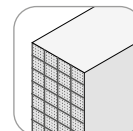

wall

Waterproofing

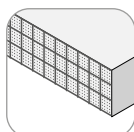

without waterproofing
(page 2)

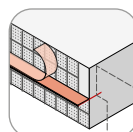

coated metal waterstop
(page 3)

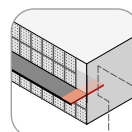

waterstop (black steel)
(page 4)

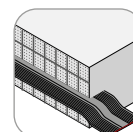

carrying cage for rubber/
PVC waterstop
(page 5)

Design options

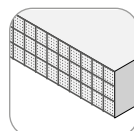

standard construction joint

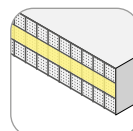

crack inducing joint

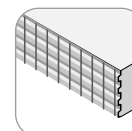

indented joint according to EC2

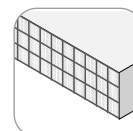

fine mesh for free flowing, self compacting concrete

Stremaform® spacer for efficient mounting

overall length L: mm
 spacing a: mm
 cover c_{nom} : mm

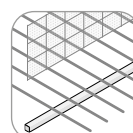
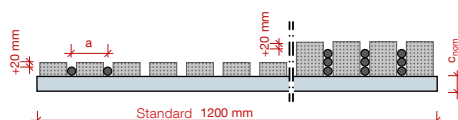

without Stremaform® spacer

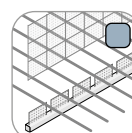

with Stremaform® spacer (square bar)

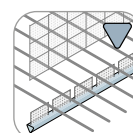

with Stremaform® spacer (triangular)

Layout

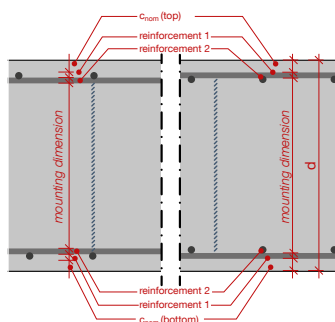

slab depth d mm

top: top cover $c_{nom\ top}$ mm

reinforcement T1 \emptyset mm , number of layers n pc.
 reinforcement T2 \emptyset mm , number of layers n pc.

mounting dimension EBM mm

bottom: reinforcement B1 \emptyset mm , number of layers n pc.
 reinforcement B2 \emptyset mm , number of layers n pc.

bottom cover $c_{nom\ bottom}$ mm

Mounting dimension - recommendation

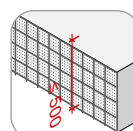

Stremaform®
h ≤ 500 mm

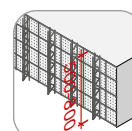

Stremaform® stiffened
500 mm < h ≤ 800 mm

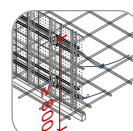

Stremaform® stiffened +
Stremaform® bracing
h > 800 mm

Order form - Stremaform® working joints without waterproofing

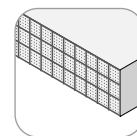

Dimension

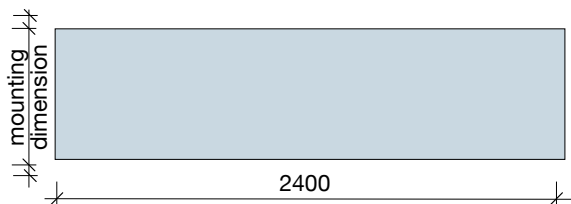

mounting dimension EBM: mm

Units

standard forms of supply

- ① Standard 2400 mm

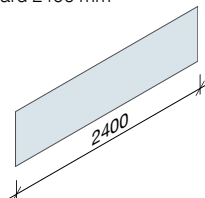

- ② Standard 1200 mm

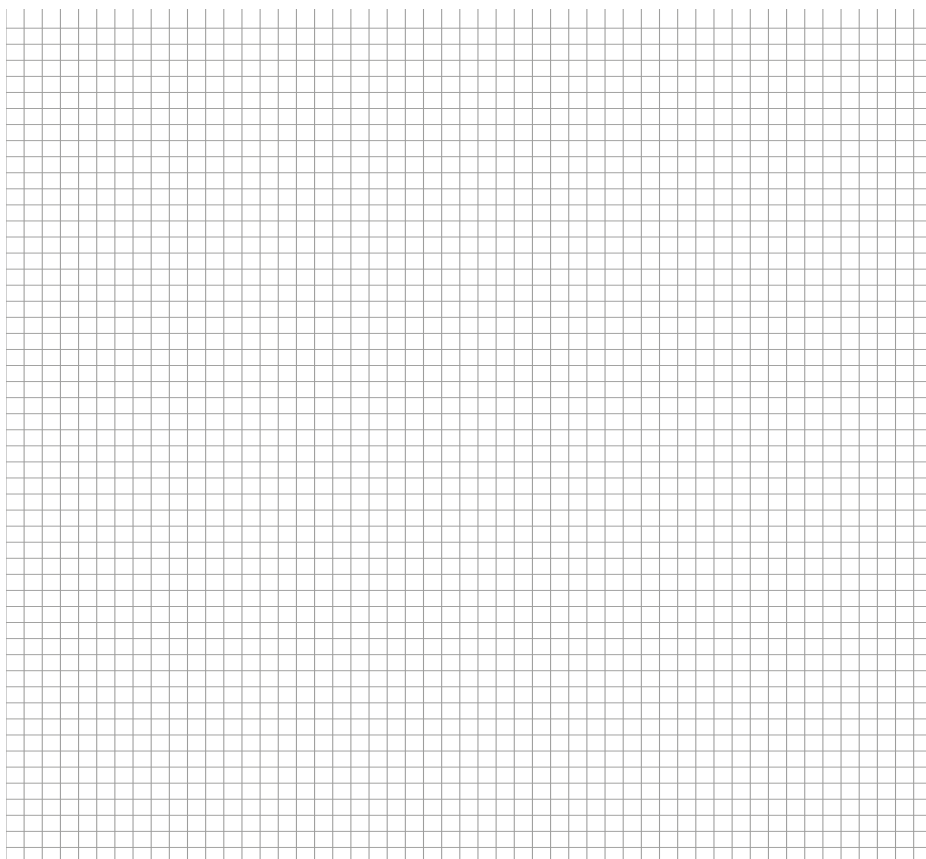
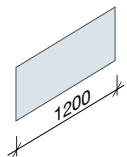

Order form - Stremaform® working joints coated metal waterstop

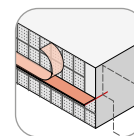

Position of the waterstop

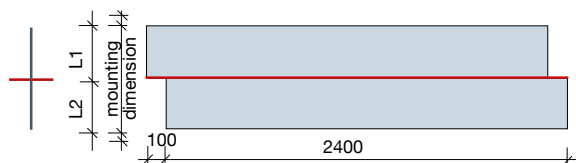

mounting dimension EBM: mm

waterstop in centre: yes no

top distance (L1) mm

bottom distance (L2) mm

Please mark up any height offsets!

Wall transition unit

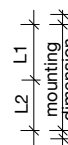
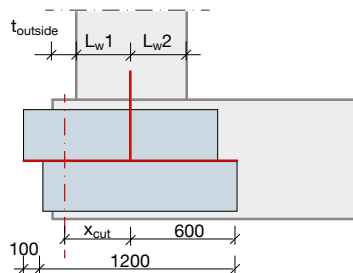

wall dimensions

$t_{outside}$ mm

L_{w1} mm

L_{w2} mm

slab dimensions

x_{cut} mm

(mounting dimension see above)

Metal waterstop

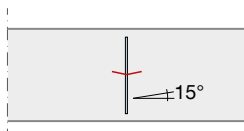

angled

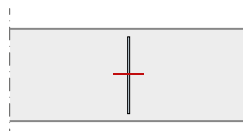

straight (standard)

type of metal waterstops

standard 150/1,5 mm

metal waterstop dimension
width/thickness =/..... mm

coating: one-sided double-sided
 (standard)

Units

forms of supply (standard)

- ① Standard 2400 mm

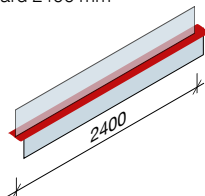

- ② Standard 1200 mm

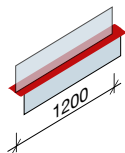

- ③ Wall transition unit

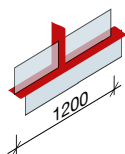

- ④ Height offset

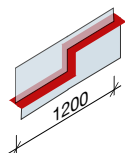

- ⑤ Corner element

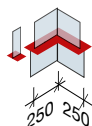

- ⑥ T-element

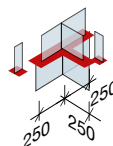

- ⑦ Crossing

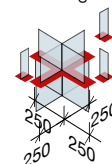

Order form - Stremaform® working joints metal waterstop (black steel)

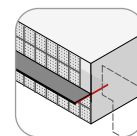

metal waterstop

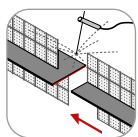

welded butt joint
(Standard)

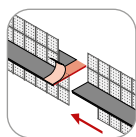

glued butt joint

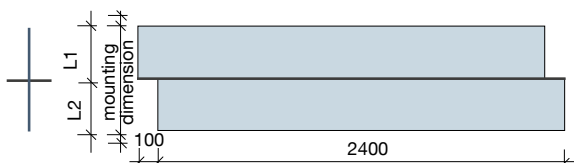

mounting dimension EBM:..... mm

waterstop in centre: yes no

top distance (L1) mm

bottom distance (L2) mm

Please mark up any height offsets!

Wall transition unit

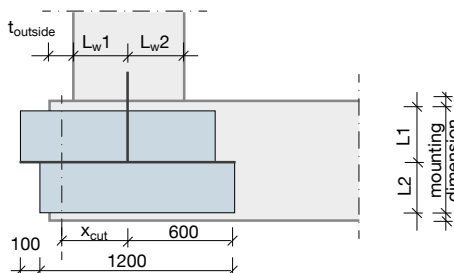

wall dimensions

$t_{outside}$ mm

L_{w1} mm

L_{w2} mm

slab dimensions

x_{cut} mm

(mounting dimension see above)

Metal waterstop

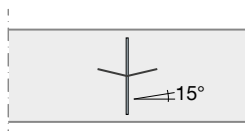

V-form (standard)

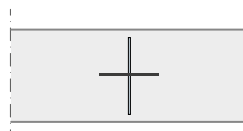

strait (tailored design)

type of metal waterstops

250/1.5 mm

250/2.0 mm

300/1.5 mm

300/2.0 mm

...../.....mm

Units

standard forms of supply

- ① Standard 2400 mm

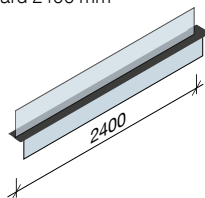

- ② Standard 1200 mm

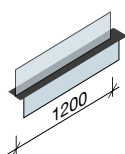

- ③ Wall transition unit

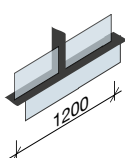

- ④ Height offset

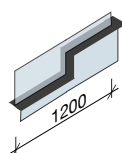

- ⑤ Corner element

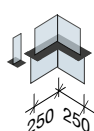

- ⑥ T-element

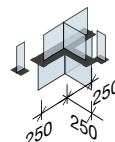

- ⑦ Crossing

